

Filling

You Tube
video tutorial

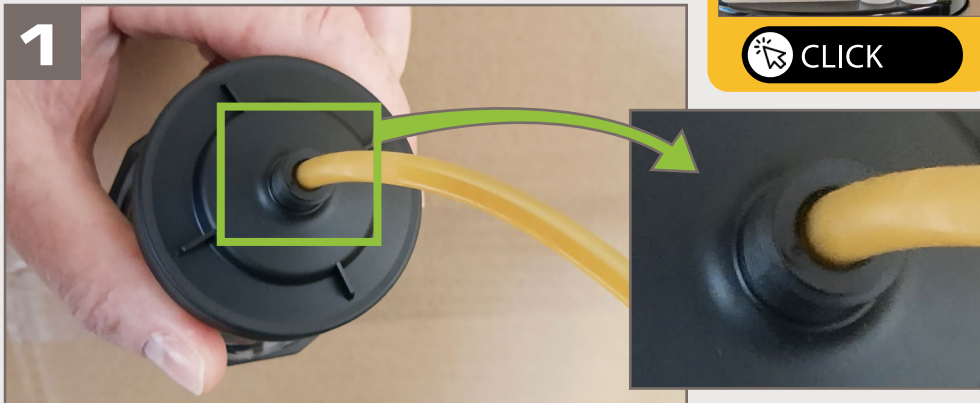

G LUBE



Insert a hose (maximum outer diameter = 6 mm) into the opening at the bottom of G-LUBE and push it as far as possible. A thicker hose would not allow the air to escape during the filling process.



Connect the hose to a grease gun or barrel pump.



While filling G-LUBE, rotate the device around its own axis to allow the lubricant to spread evenly. The number of strokes depend on the lubricant and the size of the unit. As soon as you sense a slight backpressure the device is filled completely.



Remove the hose carefully and clean the outlet. Now the device may be screwed on to the lubrication point.



If G-LUBE shall be stored, attach the plug to prevent the lubricant from leaking.

