

6. Input signal

A dispensing cycle is triggered by a signal (**HIGH 24 V DC**) lasting **between 5 and 25 seconds** from the PLC. There must be a pause of at least 25 seconds between two signals from the PLC.

We recommend a **pause of 15 minutes** between two signals, as it takes longer for the full quantity to be dispensed when using high-viscosity greases.

Input signal:

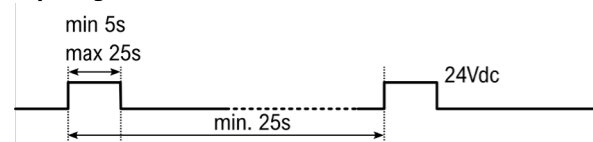

Pressure at outlet:



7. LED signals

Signals via LED



- Normal operation.
- The pump cycle has been completed successfully.



- A mechanical fault has occurred, or the pipes may be blocked.

8. Changing the cartridge

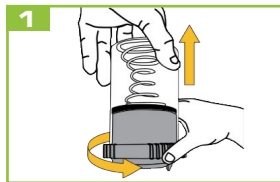

Turn the retaining ring counterclockwise and remove the housing. Remove the empty cartridge.

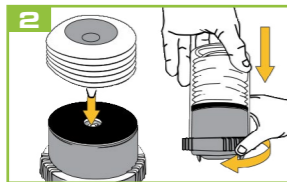

Place the new cartridge in position and place the housing on the drive unit. Secure the housing by turning the retaining ring clockwise on the drive unit.

9. Important information

- The lubricant dispenser is **not** suitable for use with oil.
- Minimize tube resistances. Narrow passages and right angles should be avoided.
- During operation of the device a visual inspection of the device as well as of the lubrication point must be carried out regularly.
- Product warranty is limited to original defects in material and workmanship and does not cover any collateral damage due to mishandling, abuse and/or any other inappropriate use of the device.
- The maximum storage temperature should not exceed +40 °C (+104 °F). Higher temperatures decrease the battery's lifespan. Batteries may be stored for max. 1 year. The lubricator has to be activated within two years from receiving.

LUBRICAJO D

User manual LJ-EM-D



1. Product details

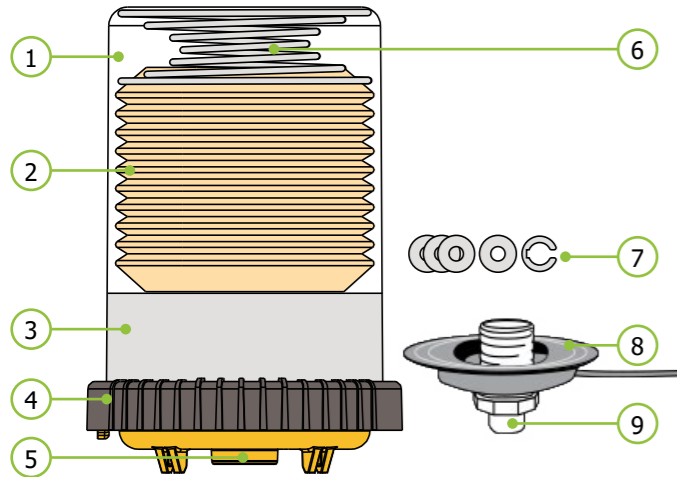

No.	Description	No.	Description
1	Housing	6	Pressure spring
2	Lubricant cartridge	7	Stroke washers, circlip (sold separately, Art. no. JAT9052)
3	Drive	8	Power adapter
4	Retaining ring	9	Thread male 1/4"
5	Outlet		

2. Technical data

Housing		
Operating temperature	-15 ... +50*	°C
Dimensions (height x Ø)	120 ml: 133 x 101 240 ml: 164 x 101 480 ml: 245 x 101	mm
Lubricant and hydraulic		
Lubricating medium	greases up to NLGI class 2	
Lubricant volume	120/240/480	ml
Number of lubrication points	up to 12 (with progressive distributors)	
Max. operating pressure	25	bar
Grease delivery	per stroke	0,6 (with stroke washers, reduction down to 0.34 ml possible)
		ml
Electrics		
Working voltage (DC)	24	V
Power supply	External power supply (min. 15 W – 0,6 A)	
Cable type	VTLB RD H03VV-F 2x0,75mm ² (200mm)	
Protection class	IP66	

* The stated value is down to the individual application and may extensively differ in some cases (depending on the lubricant and further conditions).

3. Installation

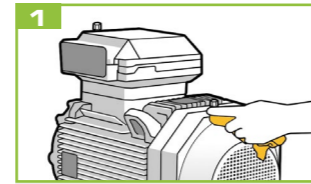

Remove any contaminants around the lube point.

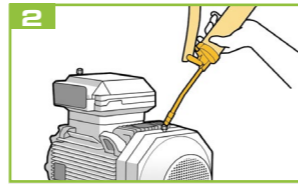

Ensure a clear passage using a manual grease gun.

NOTE The reliable operation depends on completely filled grease lines. Ensure that the grease lines are not blocked. Therefore, grease them before starting the device. Remove any hardened grease by purging the lube point with a manual grease gun.

The grease in the equipment and the grease in the unit should be the same or compatible.

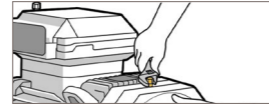

NOTE Remove the grease nipple and install proper connectors.

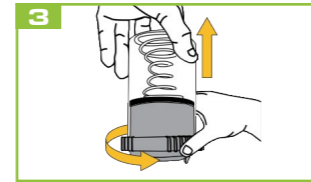

Turn the retaining ring counterclockwise and remove the housing.

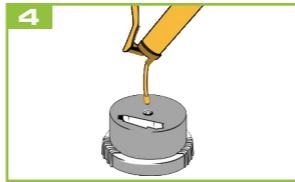
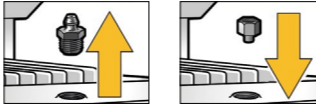

Prime the lubricator using a manual grease gun.

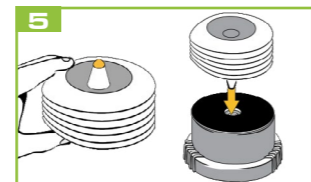

Press the cartridge gently so that some lubricant emerges, then fit it into place.



Place the housing on the drive unit. Fasten the housing by turning the retaining ring clockwise on the drive unit.

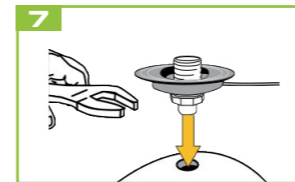

Install the power adapter at the lubrication point.

Please follow the mounting instructions under „4. Mounting“.

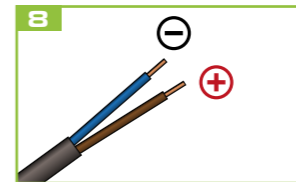

Connect the cable to a PLC. see „5. Cable assignment“



The stroke washers are used to adjust the quantity of lubricant. Please refer to the table opposite to select the amount that best suits your requirements.



If necessary, then insert the required number of stroke washers and finally the circlip (max. 7 in total).

NOTE Without stroke washers (at full piston stroke), Lubricajo D delivers 0.6 ml of lubricant per stroke. Each additional stroke washer in the ring adapter reduces the stroke volume by approximately 0.0375 ml.



Screw the lubricator onto the power adapter.



The lubricator is ready for operation. It executes the first lubrication stroke and the green LED flashes, when a corresponding signal is received from the PLC. see „6. Input signal“

Stroke washers ○ and circlip C : Setting the quantity of lubricant per stroke

max. quantity	0,6 ml
only C	0,56 ml
1 ○ + C	0,53 ml
2 ○ + C	0,49 ml
3 ○ + C	0,45 ml
4 ○ + C	0,41 ml
5 ○ + C	0,38 ml
6 ○ + C	0,34 ml

4. Mounting

Direct mounting is always preferred. If the application does not allow direct mounting, remotely assemble the unit using appropriate accessories and keep the distance from the lube point as short as possible (5 metres maximum). For **remote installations** use a 6 mm (inner diameter) tube pre-filled with the same or compatible grease as the grease contained in the unit.

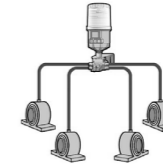

Multiple point installation is possible using a progressive distributor. Do not block any connections to the progressive distributor. Instead use a suitable distributor in accordance with the number of lubrication points. Keep the distance between the distributor and the lubrication unit as short as possible.

5. Cable assignment

Connect the cable (VTLB RD H03VV-F 2x0,75mm² (200mm)) to a PLC with a voltage of 24 V DC (min. 15 W – 0,6 A).

Ensure that the cables are connected correctly.

Colour	Assignment
brown	positive
blue	negative